

Transmission Housing

Reassembly

NOTE:

- Replace all sealing washers, oil seal and O-rings.
- Always clean the magnet ④ and oil pump strainer ⑩.

1. Reassemble the parts following the numbered sequence.

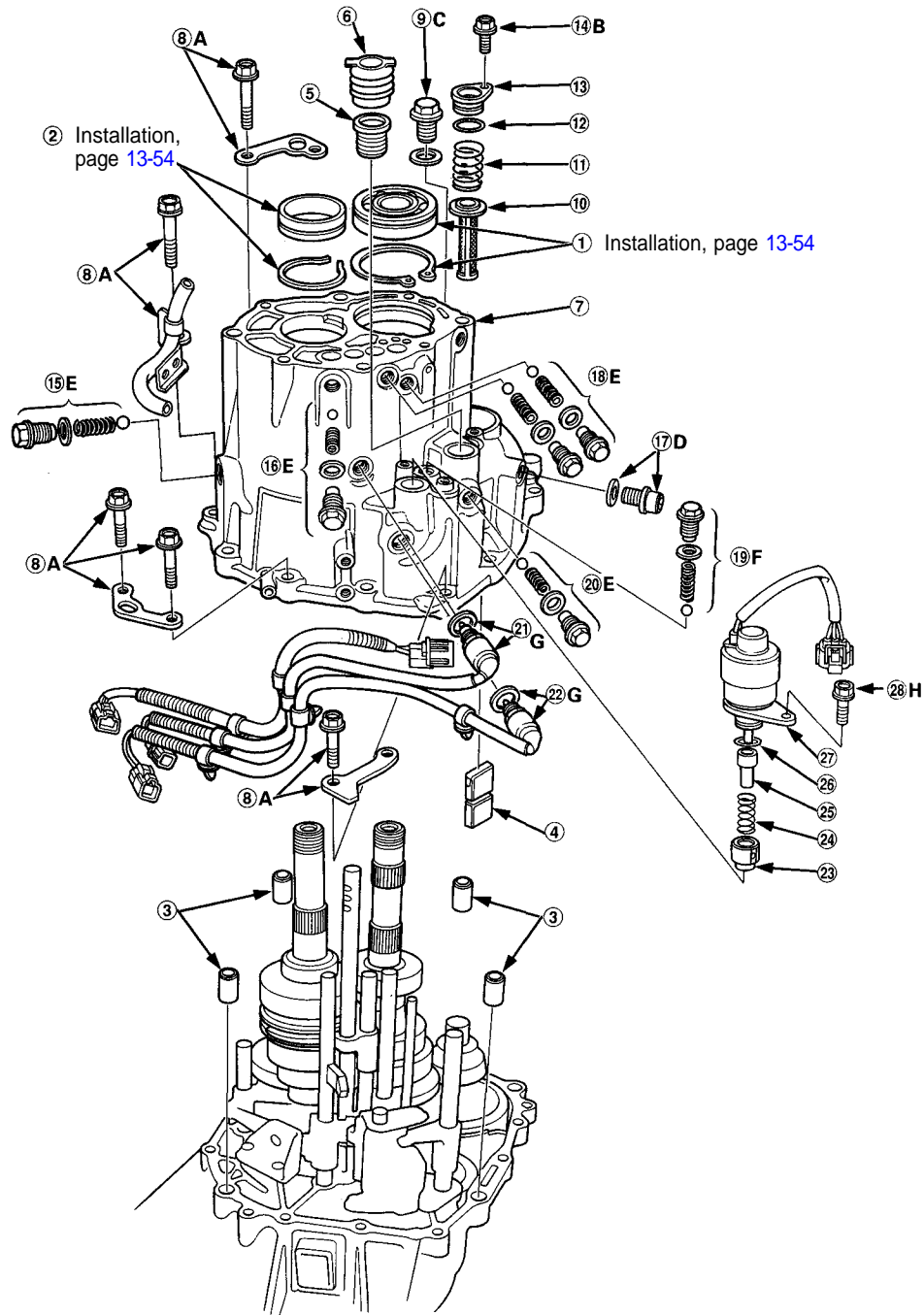



	Bolt Size	Torque Value	Sequence Number
A	10 x 1.25 mm	45 N·m (4.5 kg-m, 33 lb-ft)	⑧
B	6 x 1.0 mm	12 N·m (1.2 kg-m, 9 lb-ft)	⑭
C	DRAIN PLUG	45 N·m (4.5 kg-m, 33 lb-ft)	⑨
D	FILLER PLUG	40 N·m (4.0 kg-m, 29 lb-ft)	⑰
E	12 mm SEALING BOLT	22 N·m (2.2 kg-m, 16 lb-ft)	⑮ ⑯ ⑱ ⑳
F	14 mm SEALING BOLT	33 N·m (3.3 kg-m, 24 lb-ft)	㉑
G	SWITCH	25 N·m (2.5 kg-m, 18 lb-ft)	㉒ ㉓
H	6 x 1.0 mm	14 N·m (1.4 kg-m, 10 lb-ft)	㉔

- 1. Apply liquid gasket to the surface of the clutch housing as shown.

NOTE:

- Use liquid gasket (P/N 08718 - 0001).
- Remove any oil from the sealing surface.
- Seal the entire circumference of the bolt hole to prevent oil leakage.
- If 20 minutes have passed after applying liquid gasket, reapply it and assemble the housings and allow it to cure at least 30 minutes after assembly before filling transmission with oil.

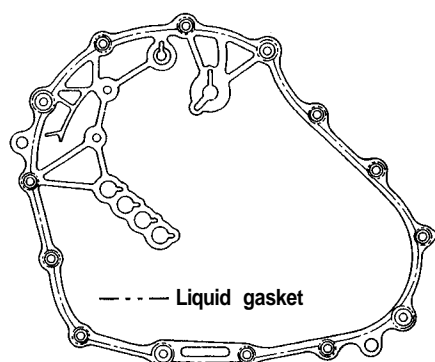

- 2. Install the oil pump strainer, strainer set spring, O-ring, and strainer cover.

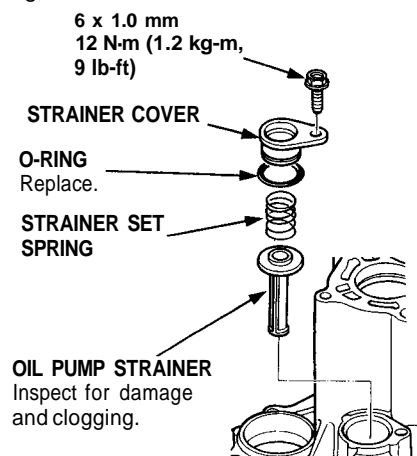

- 3. Tighten the transmission housing attaching bolts in the numbered sequence shown below.

10 x 1.25 mm
45 N·m (4.5 kg-m, 33 lb-ft)

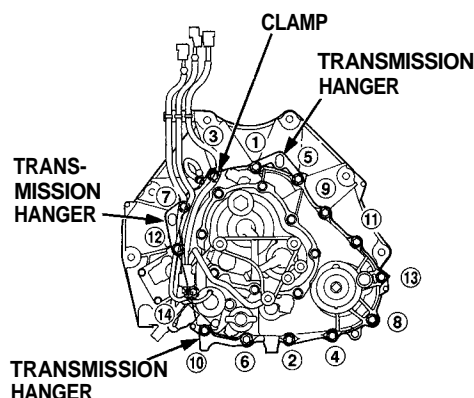

- 4. Install the steel balls, springs, sealing washers, and sealing bolts.
Replace all sealing washers.

